

**Note 'A'**  
 To operate stacked dispensers independently with two separate 3 way compressed air valves, substitute the KA2330 air block gasket for the 0129 sealing washer. Operate dispensers installed below the air block gasket with one valve, and dispensers installed above the air block gasket with the other air valve.

**Note 'B'**  
 Coupler inlet tube size must match measuring dispenser output tube size. Use KA1530 series couplers for dispensers with 3/16" tube outlets. Use KA4497 series couplers for dispensers with 5/32" tube outlets. Couplers are not available for dispensers with 1/8" tube outlets.

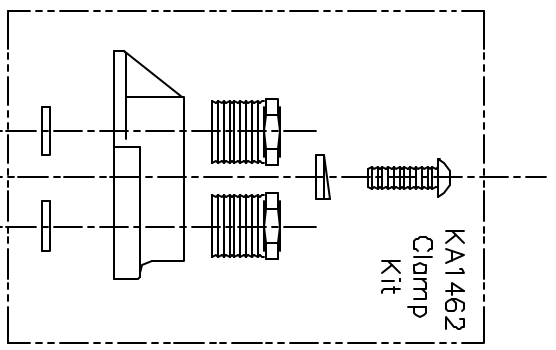

0378 Mounting stud  
 (2 required per dispenser)

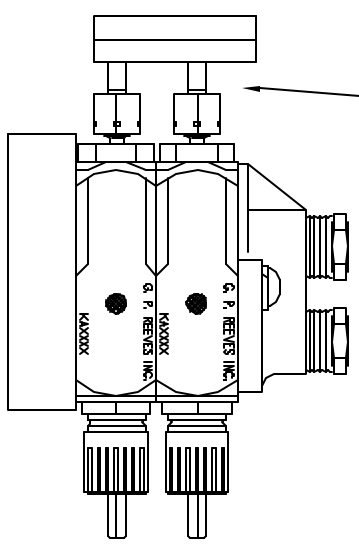
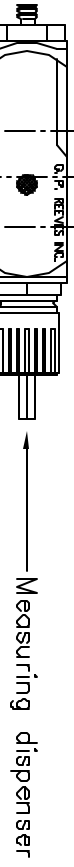

KA2330 Air block gasket  
 for use only when dispensers will be used independently by separate air valves.  
 -See Note 'A'

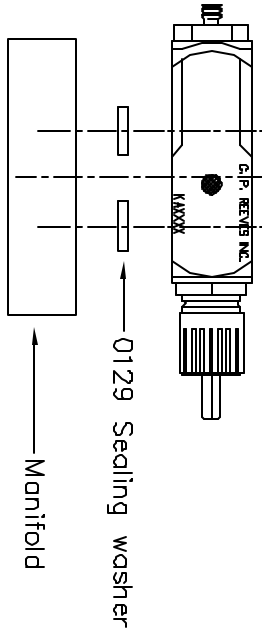

KEY	DESCRIPTION	REQ
-----	-------------	-----

G. P. REEVES INC. 8724 GREENVIEW STREET HELLAND, IN 49124, USA		
SCALE	TOLERANCES	XXXX - ± 0.003 XX - ± 0.015 XX - ± 1/32
DATE 10/09/01		JMH

THIS DOCUMENT IS THE PROPERTY OF G.P. REEVES INC. AND CONTAINS CONFIDENTIAL PROPRIETARY INFORMATION THAT IS NOT TO BE DISCLOSED TO THIRD PARTIES AND IS NOT TO BE USED WITHOUT APPROVAL IN WRITING FROM G.P. REEVES INC.

Assembly-Measuring Dispenser, Low Pressure Clamp, Manifold, Coupler, Etc. For Low Pressure Oil Or Grease Applications	
SHEET 1 of 1	DRAWING NUMBER KA4544